

NEMLİYER SERİSİ IP 44
MOISTURE PROOF RANGE IP 44





Nemliyer Serisi IP 44



18300

Anahtar/One Way Switch

Gerilim/Rated Voltage 250 V

Akım/Rated Current 10 A

Ölçüler/Dimensions 73,5x66,5x47 mm



18301

Komitatör/Two Way Switch

Gerilim/Rated Voltage 250 V

Akım/Rated Current 10 A

Ölçüler/Dimensions 73,5x66,5x47 mm



18302

Light/Light Switch

Gerilim/Rated Voltage 250 V

Akım/Rated Current 10 A

Ölçüler/Dimensions 73,5x66,5x47 mm



18303

**Vavien/Cut Out and
Two Way Switch**

Gerilim/Rated Voltage 250 V

Akım/Rated Current 10 A

Ölçüler/Dimensions 73,5x66,5x47



18304

Kapaklı Topraklı Priz

**Schuko Socket Outlet
With Cover**

Gerilim/Rated Voltage 250 V

Akım/Rated Current 16 A

Ölçüler/Dimensions 73,5x66,5x48 mm



18305

Deviatör/Deviator

Gerilim/Rated Voltage 250 V

Akım/Rated Current 10 A

Ölçüler/Dimensions 73,5x66,5x47 mm



/ Moisture Proof Range IP 44



18310

Zil Butonu/Bell Switch

Gerilim/Rated Voltage 250 V

Akım/Rated Current 10 A

Ölçüler/Dimensions 73,5x66,5x47 mm



18341

Jaluzi Anahtar

Venetian Blind Switch

Gerilim/Rated Voltage 250 V

Akım/Rated Current 10 A

Ölçüler/Dimensions 73,5x66,5x47 mm



18354

Kapaklı Topraklı + Kapaklı Topraklı

Double Schuko Socket Outlet With Cover

Ölçüler/Dimensions 123x73x59 mm



18351

Kapaklı Topraklı + Komitatör

Schuko Socket Outlet With Cover+

Two Way Switch

Ölçüler/Dimensions 123x73x59 mm



18350

Kapaklı Topraklı + Anahtar

Schuko Socket Outlet With

Cover+ One Way Switch

Ölçüler/Dimensions 123x73x59 mm

Dikey Kombinasyon Oluşturma/Setting Vertical Combination

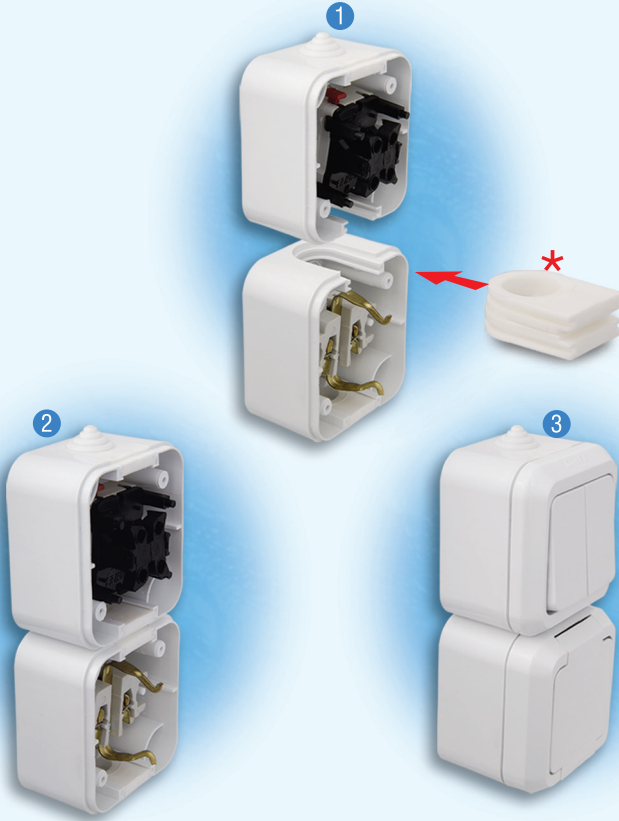

Birleşme yönündeki elastik tapaları sökünüz. Sökülen tapaların yerine şekil 1'de görüldüğü gibi parçayı takınız. Kasaların birleştirilmesiyle istenildiği kadar dikey kombinasyon oluşturabilirsiniz.

Remove elastic bungs from the connection side. Put the connector in place of removed bungs as shown in the figure. This combination method allows unlimited vertical combination as you wish.

Nemliyer Serisi IP 44 / Moisture Proof Range IP 44

Ürün/Product	Gri Grey Code	Krem Beige Code	Beyaz White Code	Kutu Ad. T. Box	Koli Ad. T. Package	Net Ağırlık Kg. Net Weight Kg.	Brüt Ağırlık Kg. Gross Weight Kg.	Koli Ebadı mm. Measurement mm.
Anahtar/One Way Switch	18100	18200	18300	10	100	10,27	12,02	32.0x37.0x39.5
Komitatör/Two Way Switch	18101	18201	18301	10	100	10,62	12,30	32.0x37.0x39.5
Light/Light Switch	18102	18202	18302	10	100	10,10	12,02	32.0x37.0x39.5
Vavien/Cut Out and Two Way Switch	18103	18203	18303	10	100	10,33	12,14	32.0x37.0x39.5
Kapaklı Topraklı + Anahtar Schuko Socket Outlet With Cover+ One Way Switch	18104	18204	18304	10	100	12,56	13,64	32.0x37.0x39.5
Deviatör/Deviator	18105	18205	18305	10	100	9,88	12,14	32.0x37.0x39.5
Zil Butonu/Bell Switch	18110	18210	18310	10	100	10,27	12,02	32.0x37.0x39.5
Jaluzi Anahtar/Venetian Blind Switch	18141	18241	18341	10	100	10,27	12,02	32.0x37.0x39.5
Kapaklı Topraklı + Anahtar Schuko Socket Outlet With Cover+ One Way Switch	18150	18250	18350	6	60	11,80	13,48	25.0x30.5x41.0
Kapaklı Topraklı + Komitatör Schuko Socket Outlet With Cover+ Two Way Switch	18151	18251	18351	6	60	11,80	13,73	25.0x30.5x41.0
Kapaklı Topraklı + Light Schuko Socket Outlet With Cover+ Light Switch	18152	18252	18352	6	60	11,80	13,48	25.0x30.5x41.0
Kapaklı Topraklı + Vavien Schuko Socket Outlet With Cover+ Cut out and Two Way Switch	18153	18253	18353	6	60	11,90	13,48	25.0x30.5x41.0
Kapaklı Topraklı + Jaluzi Anahtar Schuko Socket Outlet With Cover+ Venetian Blind Switch	18155	18255	18355	6	60	11,90	13,48	25.0x30.5x41.0
Kapaklı Topraklı + Kapaklı Topraklı Double Schuko Socket Outlet With Cover	18154	18254	18354	6	60	12,20	14,02	25.0x30.5x41.0
* Ara Tapa/Connector	18111	18211	18311	50	—	0,240	3,73	19.4x24.3x41.2